

# **NCERT SOLUTIONS**

**CLASS - 4th**



*aglasem.com*

Q1 Draw how the fan looks from below.

Answer. DIY

Page : 52 , Block Name : Gappu's Air Journey

Q2 Look for these things in the photo.

Answer. DIY

Page : 52 , Block Name : Gappu's Air Journey

Q3 Can you think why Gappu could see the cheese on the jug but Chinky could not?

Answer. Gappu could see the cheese placed on the top of the jug as he was seeing it from the above. But Chinky could not see the cheese because she was running on the floor.

Page : 53 , Block Name : Gappu's Air Journey

Q4 When I ran around in my house, it looked so big! But from here, it looks small. How is that?

Answer. When we see things from nearby, they look big room. When we The balloon flew up and Gappu started going up in the sky. As he looked down, he could see his house, see the same things from high above, they look small.

Page : 53 , Block Name : Gappu's Air Journey

Q5 Imagine how your classroom looks from above. Try to draw it and mark the benches, blackboard, doors, windows etc

Answer. DIY

Page : 54 , Block Name : Gappu's Air Journey

Q6 Look at these pictures and discuss why things look wide and big at this end but narrow and small at the other end.



Answer. Things look wide and big at the end close to us, whereas they look narrow and small at the end away from us.

Page : 55 , Block Name : Gappu's Air Journey

Q1 Only one of the photos below is the correct match of the same yoga pose. Mark it.



Answer. The first photo from the left is the correct match of yoga pose shown in the picture.

Page : 55 , Block Name : Match Two Views Of The Same Pose

Q2 These are two different views of the same bowls.

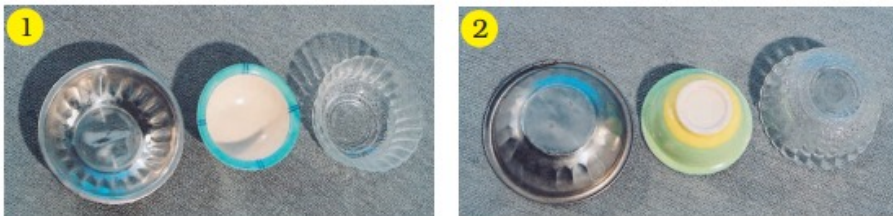

(i) In which photo are the bowls upside down?  
Look at the side view in photo 3 to find the answer.



(ii) Draw lines to match the side view with the top view of

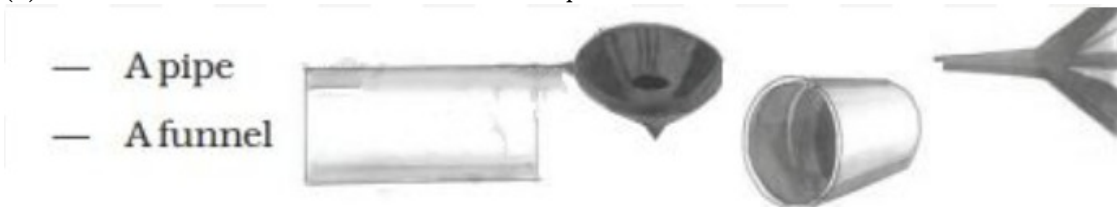

(iii) Try to draw pictures of a shoe from the side, top, front etc.

Answer. (i) In the second photo, the bowls are upside down.

(ii) The matching of the side view with the top view is as under the following:

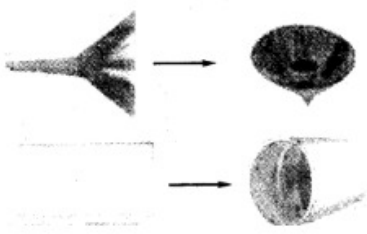

(iii)

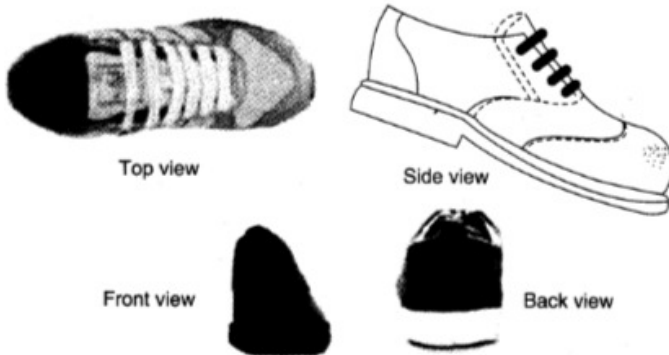

Page : 56 , Block Name : Match Two Views Of The Same Pose

Q3 Do you remember the park behind Gappu's house? Here is a bigger picture of that park. Look at it carefully and answer the questions.

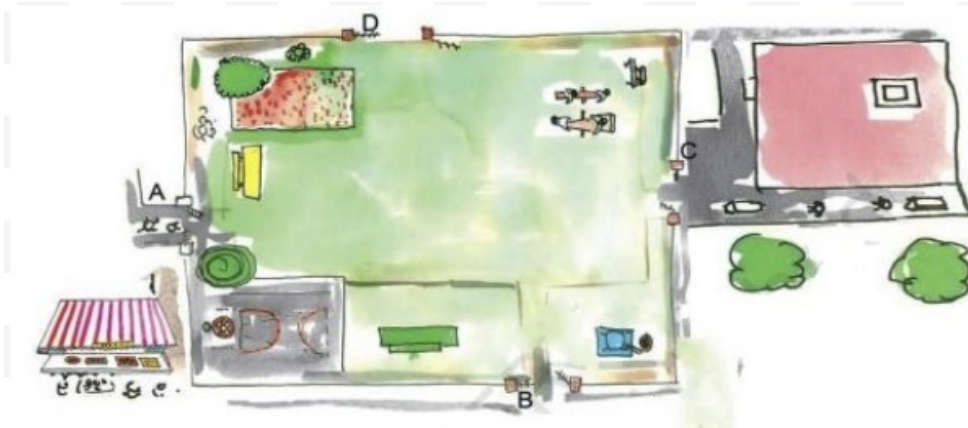

- Mark the gate nearest to the sweet shop.
- Which gate is nearest to Gappu's house?
- If you enter from gate B, the green bench will be to your — Left / Right / Front.
- When Suhasini entered the park, the flower bed was to her right. Which gate did she enter from?
- Which of these is nearest to you if you enter from gate C?

1. Basketball court.
2. Flower bed.
3. Green bench.
4. See-saw.

Answer.

- The gate nearest to the sweet shop is A.
- Gate C is nearest to Gappu's House.
- On entering from gate B, the green bench will be our left.
- Suhasini entered the park through gate D.
- See-saw is nearest to me if I enter from gate C.

Page : 57 , Block Name : The Park Behind Gappu's House

Q1 Did Ismail go wrong somewhere? Can you correct him?

Answer. Yes, Ismail your house, reach the milk booth and then take the left turn. From the second crossing take a right turn and go over the bridge.

Page : 58 , Block Name : Ismail's Home

Q2 Show where Srijata will reach if she takes the route he told her.

Answer. Srijata will reach in the opposite direction of Ismail's house.

Page : 58 , Block Name : Ismail's Home

Q3 Write the directions for going from Ismail's house to Srijata's house.

Answer. The required directions are:

"From Ismail's house in the side lane come to the main road, cross the park and then take the first right turn go over the bridge. Go straight and then take a left turn. From the second crossing take a right turn and you will reach Srijata's house up in the lane.

Page : 58 , Block Name : Ismail's Home

Q1 Can you guess what that box-like thing was? The numbers on the opposite faces of this box add up to 7.

- Which number was on the opposite side of 5?
- In the picture, which number will be at the bottom?
- Which number will Gibli see if she again turns left from 5?
- What will this box look like if you opened it up? Mark the correct picture

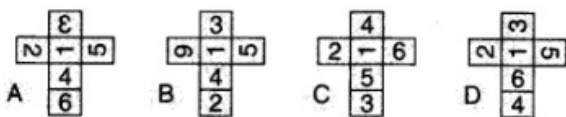

Answer. It was a dice.

- The number of opposite side of 5 is 2. (because of  $7 - 5 = 2$ )
- The number at the bottom is 6 (because of  $7 - 1 = 6$ ).

- On turning left from 5, Gibli will see the no. 1
- The box looks like the figure given in 'A', if it would be opened.

Page : 59 , Block Name : Gibli And The Big Box

Q1 Draw a shape like this on a thick paper. Cut it out and colour the different faces in different colours. Can you use this box to play a game?

Answer. DIY

Page : 59 , Block Name : Try It Out